

ELPRO ELECTROL

Projecta BV
P.O. Box 191, 6000 AD Weert
Franklinstraat 14
6003 DK Weert
The Netherlands
Tel: +31 (0) 495580840
Fax: +31 (0) 495580845
sales@projectascreens.com
www.projectascreens.com



PROJECTA
Screens for Professionals

SUGGESTED SPECIFICATIONS

Electrically operated projection screen 230 volt (50Hz) with a usage of no more than 0.53 Ampere. The motor is mounted on the left side in the steel casing with rubber dampers to reduce sound. The motor is mounted inside the roller, 4 wire, 32 rotations per minute, maintenance free, integrated brake and thermal overload cut-out. The end positions are pre-set, but can be adjusted afterwards. The 4 wire connection is integrated into the end cap and can be connected to the electric installation with the connector and standard cable. Suitable for wall and ceiling mounting with the supplied flexible mounting brackets (50cm). The steel square casing (11,8x11,8cm) is galvanised on the inside and on the outside powder coated with a matte structure coating (RAL 9016). The grey end caps close the casing on both ends. The triangular slat bar closes off the bottom of the casing completely. The screen fabrics are flame retardant and seamless. The projection fabrics have a 5 cm. border all around with the Video, HDTV, and Wide format. The standard format (1:1) has a black border on both sides (width $\leq 240\text{cm} = 2.5\text{cm}$ and $> 240\text{cm} = 5\text{cm}$). The projection fabrics have a black backing. Standard 3 position wall switch is supplied. The projection screen is tested and monitored by the TÜV/GS programme (EN 60335-1: 2002+A1+A11+A12+A2+A13, EN6035-2-97:2006 and DIN 19045-5/01.84) and CE marked and satisfies the strictest quality and safety requirements.

SCREEN SURFACES

All screen fabrics are seamless.

Matte White; Gain 1.0, viewing angle 120°, Flame retardant, max. height 300 cm, max. width 300 cm.

High Contrast; Gain 1.0, viewing angle 120°, Flame retardant, max. height 300 cm, max. width 300 cm.

Datalux; Gain 1.5, viewing angle 70°, Flame retardant, max. height 240 cm, max. width 300 cm.

High Power; Gain 2.8 viewing angle 70°, Flame retardant, max. height 200 cm, max. width 240 cm.

DIMENSIONS (SELECT ONE OF OUR STANDARD SIZES AND ENTER THE REQUIRED QUANTITY)

Aspect Ratio	Screen Size	Viewing Size	Nominal Diagonal		Case (RAL 9016)			Weight	Screen Surfaces			
	h x w cm	h x w cm	cm	inches	L1 (mm)	L2 (mm)	L3 (mm)	in kg	Matte White	High Contrast	Datalux	High Power
4:3	123 x 160	110 x 146	183	72	1715	729-1529	1620	17				
4:3	138 x 180	126 x 168	210	83	1915	929-1729	1820	19				
4:3	153 x 200	143 x 190	238	94	2135	1149-1949	2040	21				
4:3	168 x 220	158 x 210	263	103	2335	1349-2149	2240	23				
4:3	183 x 240	173 x 230	288	113	2535	1549-2349	2440	26				
4:3	213 x 280	203 x 270	338	133	2935	1949-2749	2840	30				
4:3	228 x 300	218 x 290	363	143	3135	2149-2949	3040	33				
16:9	90 x 160	82 x 146	168	66	1715	729-1529	1620	16				
16:9	102 x 180	95 x 168	193	76	1915	929-1729	1820	17				
16:9	117 x 200	107 x 190	218	86	2135	1149-1949	2040	20				
16:9	128 x 220	118 x 210	241	95	2335	1349-2149	2240	22				
16:9	139 x 240	129 x 230	264	104	2535	1549-2349	2440	25				
16:9	162 x 280	152 x 270	310	122	2935	1949-2749	2840	28				
16:9	173 x 300	163 x 290	333	131	3135	2149-2949	3040	30				
16:10	129 x 200	119 x 190	224	88	2135	1149-1949	2040	20				
16:10	141 x 220	131 x 210	248	97	2335	1349-2149	2240	22				
16:10	154 x 240	144 x 230	271	107	2535	1549-2349	2440	25				
16:10	179 x 280	169 x 270	318	125	2935	1949-2749	2840	28				
16:10	191 x 300	181 x 290	342	135	3135	2149-2949	3040	30				
1:1	160 x 160	151 x 151			1715	729-1529	1620	18				
1:1	180 x 180	173 x 173			1915	929-1729	1820	19				
1:1	200 x 200	195 x 195			2135	1149-1949	2040	23				
1:1	220 x 220	215 x 215			2335	1349-2149	2240	25				
1:1	240 x 240	230 x 230			2535	1549-2349	2440	29				
1:1	280 x 280	270 x 270			2935	1949-2749	2840	33				
1:1	300 x 300	290 x 290			3135	2149-2949	3040	37				

CUSTOM SOLUTIONS

Give exact the sizes of the projection screen you need:

Viewing size: _____ Height (cm.) x _____ width (cm.) Surface: _____

Border top: _____ (cm.) Border bottom: _____ (cm.)

Border left: _____ (cm.) Border right: _____ (cm.)

RAL color case and plastic parts: RAL _____

☐ Screen fabric mounted reversely

☐ Motor positioned on right side ☐ Silent motor

Remarks: _____

www.projectascreens.com/screendesigner

ACCESSORIES FOR OPERATION

- ☐ Easy Install RF remote control (868,3 Mhz)
 - ☐ Easy Install wireless projector coupling (868,3 Mhz)
 - ☐ Easy Install wireless RF wall switch (868,3 Mhz)
- ☐ Easy Install RF remote control with projector coupling (868,3 Mhz)
- ☐ Easy Install projector coupling with cable (868,3 Mhz)
- ☐ Easy Install IR remote control (868,3 Mhz)
- ☐ Easy Install plug & play relaybox with potential free contacts (868,3 Mhz)
 - ☐ Easy Install plug & play RS232/RS422 control kit
 - ☐ Easy Install plug & play RS232/RS422 with IP control kit
- ☐ Keyswitch

ACCESSORIES FOR MOUNTING

- ☐ Ceiling brackets (100 cm.)
- ☐ Set extension brackets (75 cm.)
- ☐ Set extension brackets (30 cm.)
- ☐ Set extension brackets (10 cm.)
- ☐ Set wall clamps
- ☐ Bracket kit for easy mounting in soffit

DIMENSIONS

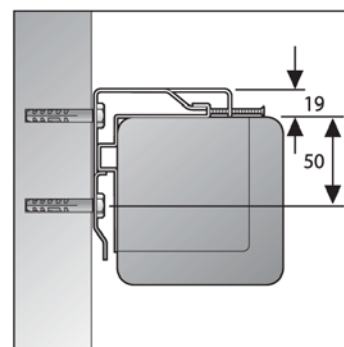
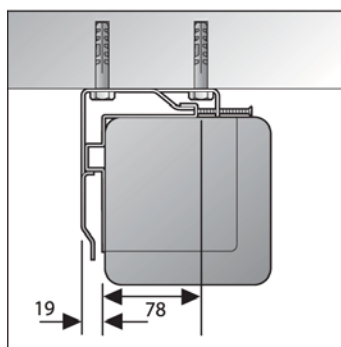
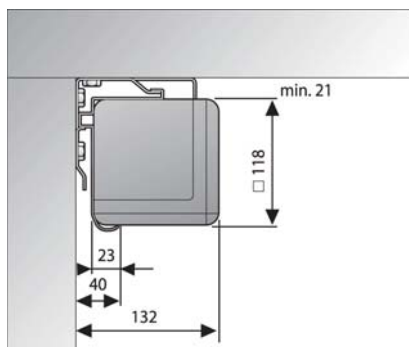

INSTALLATION

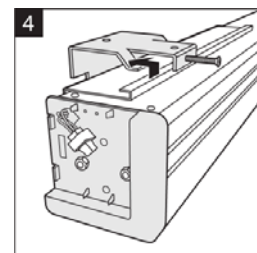
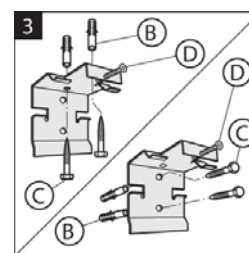
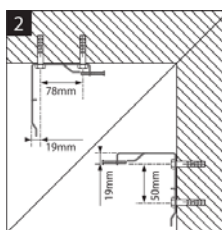
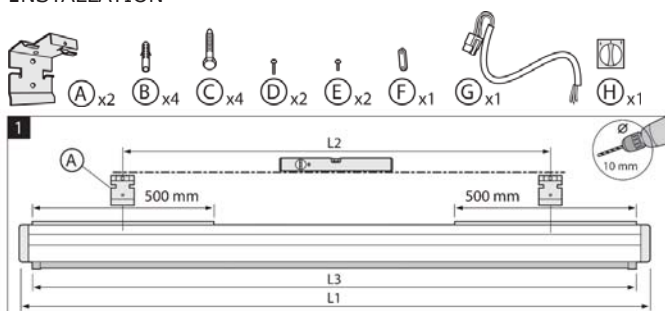

Project:	_____
Architect:	_____
Phone:	_____
Contractor:	_____
Phone:	_____
Supervisor:	_____
Phone:	_____
Supplier:	_____
Date:	_____
Revised:	_____

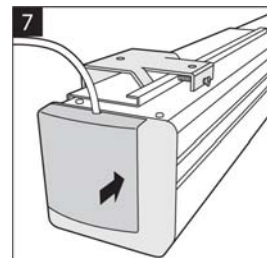
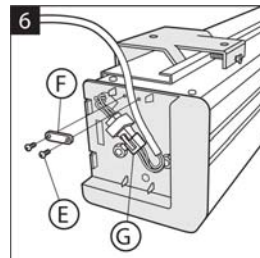
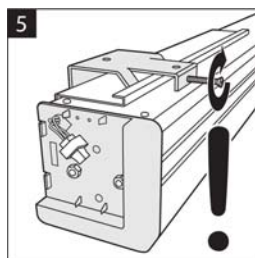

www.projectascreens.com